

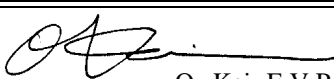

SERVICE BULLETIN

SERVICE GROUP, WARRANTY & SERVICE DEP.
MITSUBISHI MOTOR SALES EUROPE BV

SERVICE BULLETIN	NO.: ESB-96E52-001	
	DATE: 1996-05-15	<MODEL> <M/Y> (EC,EXP)CARISMA 96-00
SUBJECT: ESTABLISHMENT OF REAR SEATBACK COVER REPLACEMENT PROCEDURE		
GROUP: INTERIOR		
INFORMATION:	 O. Kai -E.V.P. After Sales Service	

1. Description

This Service Bulletin informs you that the rear seatback cover replacement procedure Has been established.

2. Effective Date:

3. Applicable Manual:

Manual	Pub. No.	Page(s)
'96 CARISMA Workshop Manual	PWDE9502 (English)	52A-13
	PWDS9503 (Spanish)	
	PWDF9504 (French)	
	PWDG9505 (German)	
	PWDD9506 (Dutch)	
	PWDW9507 (Swedish)	
	PWDI96E1 (Italian)	

4. Details:

Please refer to the attached pages.

REAR SEAT REMOVAL AND INSTALLATION

52200180036

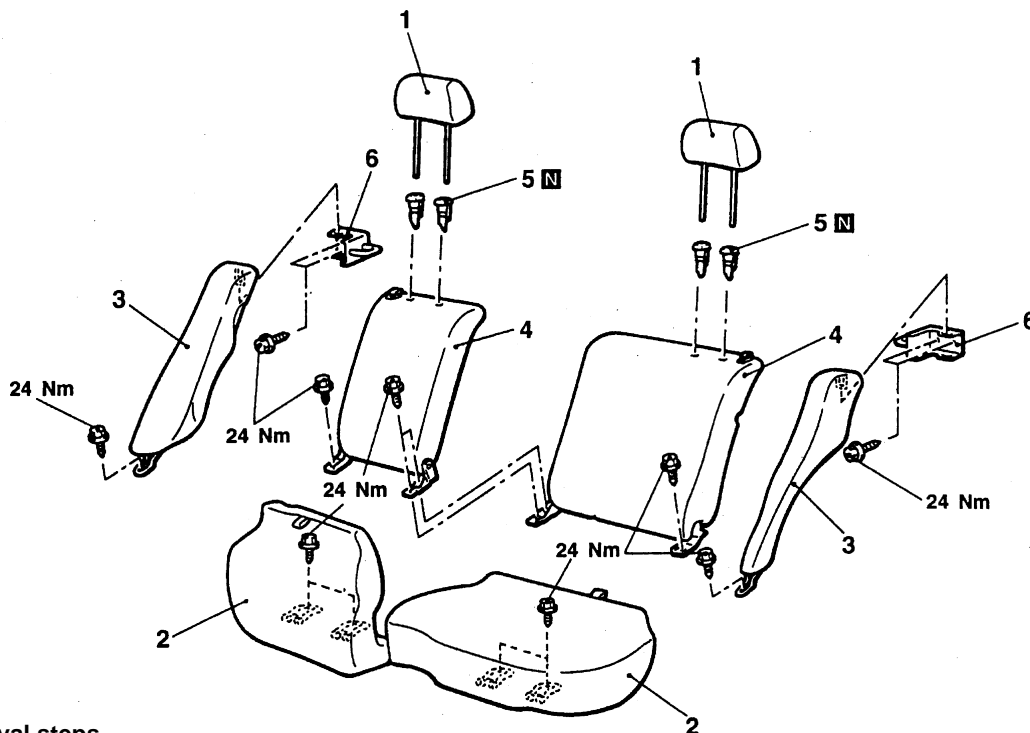

Removal steps

1. Headrest
2. Seat cushion
3. Side seatback assembly

4. Rear seatback assembly
5. Headrest guide
6. Rear seat striker

A19U0066

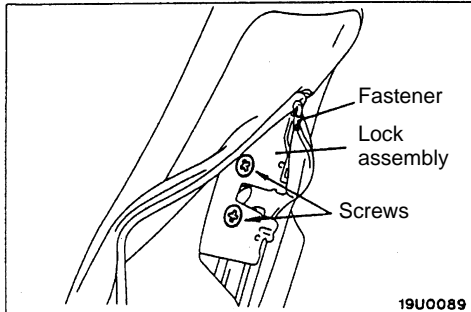

19U0089

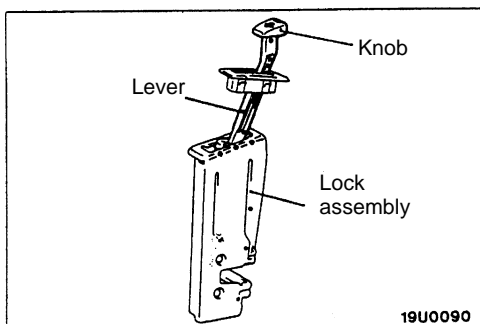

19U0090

• REMOVAL SERVICE POINTS REAR SEATBACK COVER REMOVAL

- (1) Remove the trim clips from the back (7 places) and both sides (4 places) of the rear seatback cover.
- (2) Unfasten the fastener to remove the lock assembly mounting screws.

- (3) Remove the lock assembly from the rear seatback.

Caution

- Never remove the knob from the lever.

- (4) Remove the hog ring to remove the rear seatback cover.

• INSTALLATION SERVICE POINTS REAR SEATBACK COVER INSTALLATION

- (1) While laying the rear seatback cover over the rear seatback frame pad assembly, install the hog ring on the front of the rear seatback. Use hog ring pliers to install the hog ring.
- (2) Install the lock assembly.
- (3) Install the trim clips.
- (4) Using hog ring pliers, install the hog ring on the back of the rear seatback.